

SECTION II

TM 9-2330-267-14&P

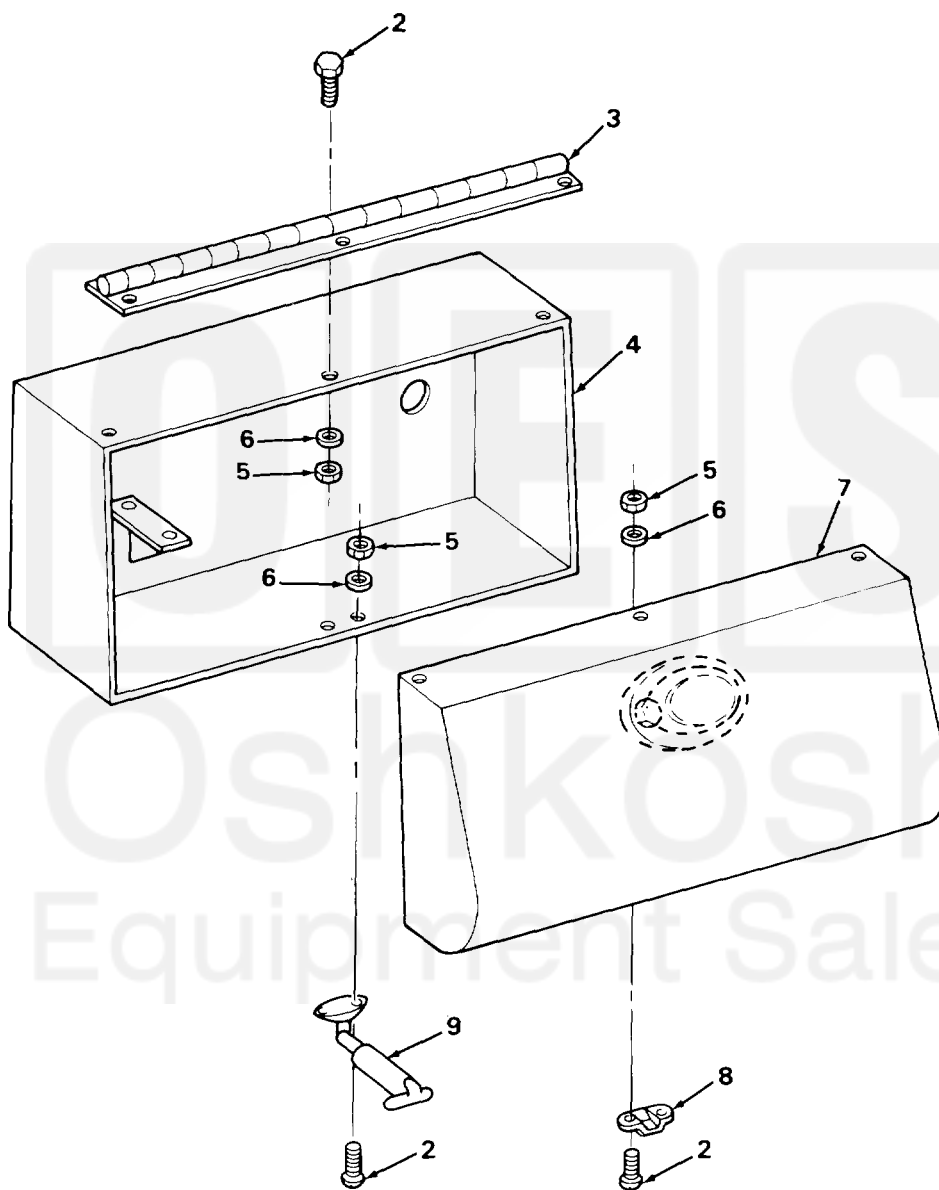
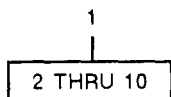

TA506243

FIGURE 21. FAUCET BOX ASSEMBLY.

SECTION II (1)	SMR (2)	CAGEC (3)	TM9-2330-267-14&P PART NUMBER (4)	DESCRIPTION AND USABLE ON CODES (UOC) GROUP 1501 FRAME ASSEMBLY FIG. 21 FAUCET BOX ASSEMBLY (5)	QTY (6)
1	PAOOO	19207	7035486	BOX,ACCESSORIES STO LEFT HAND	1
1	PAOOO	19207	7035487	BOX ASSEMBLY,RH	1
2	PAOZZ	03538	N22P21006C6	.SCREW,CAP,HEXAGON H	10
3	PAOZZ	19207	7037002	.HINGE,BUTT	1
4	PAOZZ	19207	7035451	.BOX,SMALL PARTS LEFT HAND	1
4	PAOZZ	19207	7035452	.BOX,SMALL PARTS RIGHT HAND	1
5	PAOZZ	96906	MS51967-2	.NUT,PLAIN,HEXAGON	10
6	PAOZZ	96906	MS35338-44	.WASHER,LOCK	10
7	PAOZZ	19207	7034748	.COVER,ACCESS	1
8	PAOZZ	19207	7697483	.BRACKET HOOD CATCH	1
9	PAOZZ	19207	7539197	.FASTENER,CYLINDER,S	1

END OF FIGURE

